

## RESERVEDELER COSMETAL HI-CLASS Premium 45

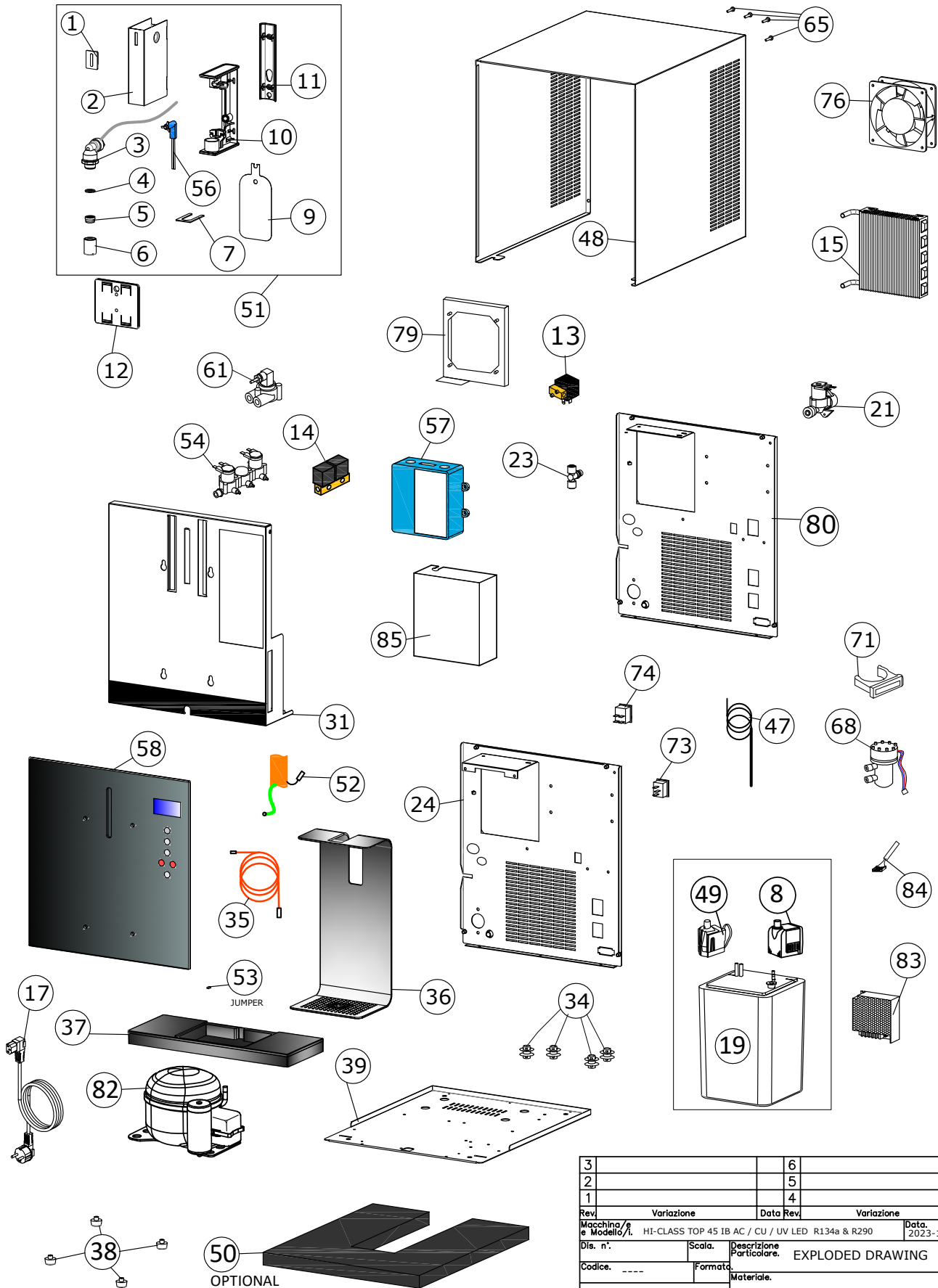

# Reservedelstegning Hi-Class 45 IBAC

HI-CLASS TOP 45 IB AC / CU / UV LED R134a & R290



3		6		
2		5		
1		4		
Rev.	Variazione	Data Rev.	Variazione	Data
Macchina/e e Modello/I. HI-CLASS TOP 45 IB AC / CU / UV LED R134a & R290				Data. 2023-11-28th
Dis. n.		Scala.	Descrizione Particolare. EXPLODED DRAWING	
Codice. ----		Formato.	Materiale.	
COSMETAL		Trattamento.		Disegnato da.
Drinking water solutions		Note.		Nome File .DWG.

QUESTO DISEGNO È TUTELATO DALLE LEGGI SUL COPYRIGHT - I TRASGRESSORI SARANNO PERSEGUITI A NORMA DI LEGGE

# Beskrivelse

POS:	COSMETAL	CELLI	DESCRIPTION
1	170111439	303361	Transparent plastic
2	170111435	303357	Dispenser cover stainless steel
3	304498 2521307	304498 304272	Brass elbow 3/8M-8 (CU-AG models) Elbow 3/8M-6
4	2661526	304943	Gasket for perlator
5	304262 2521120	304262 304252	Silver aerator (CU-AG models) Aertor in plastic
6	304267 2521119	304267 304251	Nozzle longer stainless steel (CU-AG models) Nozzle short standard stainless steel
7	170111443	303365	Fork stainless steel
8	227078	227078	Pump NEWA MC450 230/1/50-60
9	170111436	303358	Sliding cover
10	170111438	303360	Dispenser support
11	170111441	303363	Rear cover
12	170111442	303364	Friction element
13	2641128 228219	208158 228219	Brass solenoid valve 1 in - 1 out 1/8FF 230/1/50 Alternative brass solenoid valve CEME 1 in - 1 out 1/8FF 230/1/50
14	304854	304854	Brass solenoid valve 2 in - 1 out 1/8FF 230/1/50
15	1601124	272027	Condenser
17	3821718	306071	Shuko power cord
19	307820 307847 214419 215326	307820 307847 214419 215326	Complete ice bank Hi-Class 45 AC R134a Complete ice bank Hi-Class 45 AC CU R134a Complete ice bank Hi-Class 45 AC R290 Complete ice bank Hi-Class 45 AC CU R290
21	2641141 226098	210095 226098	Inlet solenoid valve 3/4M-6 230/1/50 Alternative EKI inlet solenoid valve 3/4M-6 230/1/50
23	2521562	304488	Flow regulator 6-6
24	303325	303325	Rear panel version R134a
31	308743	308743	Front panel
34	272026	272026	Anti-vibration support for compressor
35	3821961	306311	Connection cable
36	170111434	303356	Front element stainless steel
37	099283 302142	302029 302142	Complete drip tray Optional drip tray with drainage
38	2781686	272018	Foot 10 mm
39	170111357	303266	Base Hi-Class 45
47	3823961	209605	Ice bank sensor
48	303326	303326	Black cabinet
49	1501521	207934	Agitator Micromega 230/1/50
50	305649	305649	Optional base Hi-Class 45
51	099297	302041	Complete head kit Hi-Class 45 (not CU models)
52	3823006	306482	EMI filter
53	3821959	306309	Small black jumper
54	2641140	208093	Solenoid valve 2 in - 1 out 230/1/50
56	306633	306633	Blue LED
57	3823977 221063	209608 221063	Power PCB (standard) Power PCB with UV LED function
58	209611 221064	209611 221064	Complete front glass standard Complete front glass with UV LED function
61	3823001 3822938	306477 208127	Brass flow meter 1/4FF Plastic flow meter 1/4FF

## Beskrivelse

POS:	COSMETAL	CELLI	DESCRIPTION
65	306752	306752	Screws M4x12 for cabinet closure
68	304591	304591	UV LED reactor Klaran
71	306506	306506	Plastic support for UV reactor
73	040963	040963	IEC panel connector
74	3822714 215789	208160 215789	Main switch green for R134a Main switch black for R290
76	1761101604 304185	208963 304185	Condenser fan 120x120x25 for R134a Condenser fan 120x120x25 for R290
79	213000	213000	Conveyor
80	212127	212127	Rear panel R290 version
82	1581182 302587	302570 302587	Compressor Danfoss TL3F 230/1/50 for R34a Compressor Cubigel NBC22RA 230/1/50-60 for R290
83	216209	216209	Transformer 230-24VAC
84	220258	220258	Voltage divider
85	213490	213490	Sheet metal cover for power PCB

HI-CLASS TOP 45 IB AC

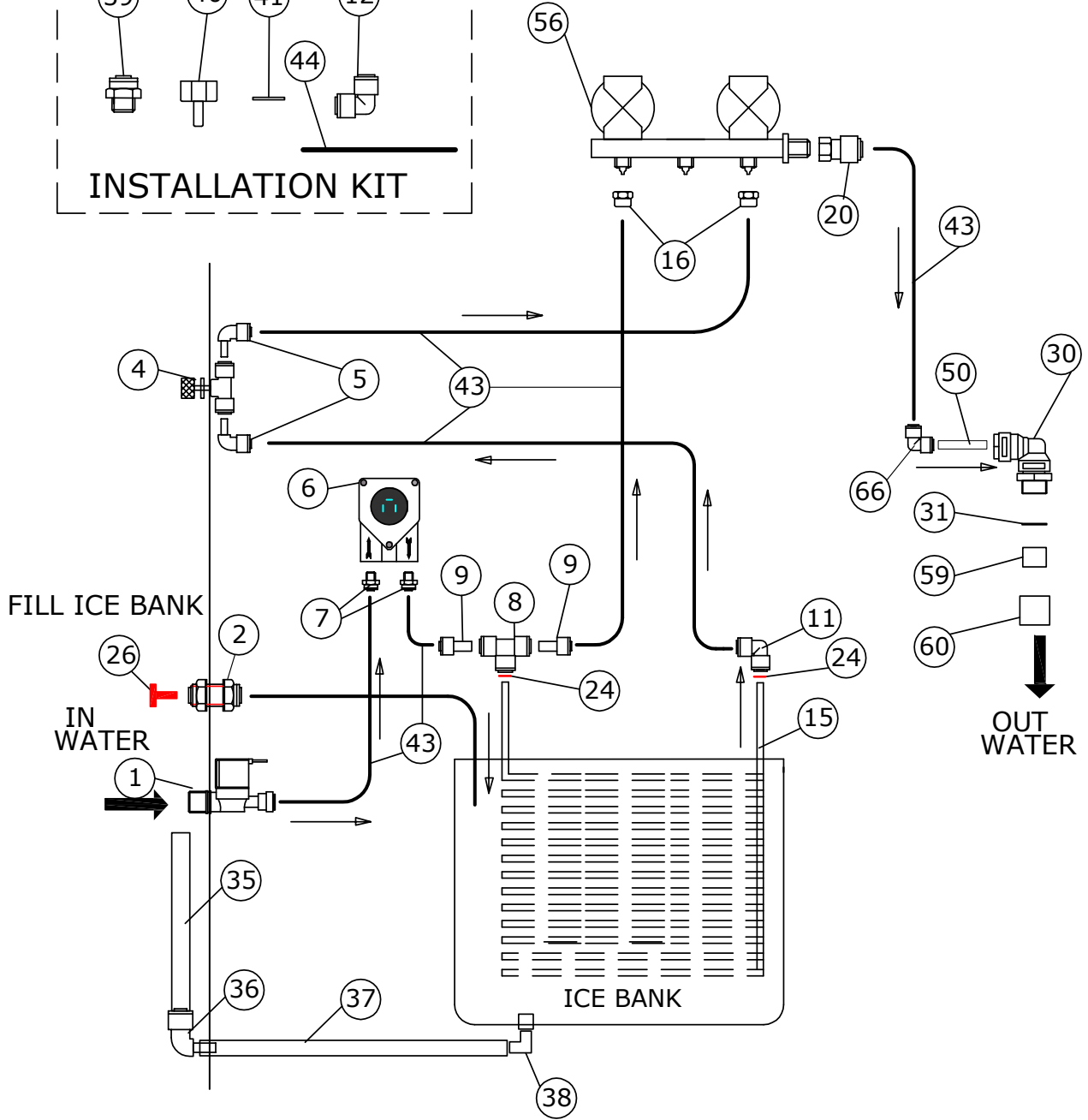
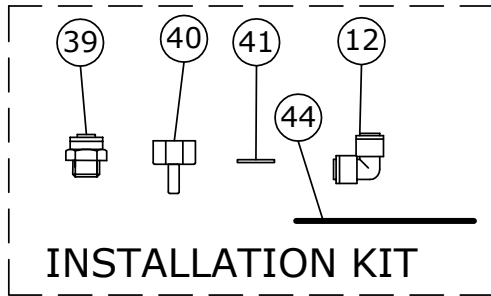

2			
1			
Data: 11-6-2024		MACCHINA HI-CLASS TOP 45 IB AC	
COSMETAL		Descrizione HYDRAULIC DIAGRAM	
		Note.	

QUESTO DISEGNO E' TUTELATO DALLE LEGGI SUL COPYRIGHT - I TRASGRESSORI SARANNO PERSEGUITI A NORMA DI LEGGE

## Beskrivelse

POS:	COSMETAL	CELLI	DESCRIPTION
1	2641141 226880	210095 226880	Inlet solenoid valve 3/4M-6 230/1/50 Alternative SEME inlet solenoid valve 3/4M-6 230/1/650
2	2521490	272073	Bulkhead connector 8-6 HMM0806
4	2521562	304488	Flow regulator 6-6 ambient water
5	2521454	272105	Stem elbow 6-6 PM220606E
6	3822938	208127	Plastic flow meter 1/4FF
7	2521413	008642	Straight connection 1/4M-6 PM010612E
8	2521364	271984	T fitting JG8 PM0208E
9	2521453	272104	Straight reduction Stem 8 - 6 PM060806E
11	2521436	272034	Reduction elbow 8-6 PM210806E
12	2521367	272166	Elbow 8-8 PM0308E
15	1601494	302766	Water coil ø8 45l/h
16	4741312	208168	Nut
20	2521420	208119	Fitting 1/4F-6 PM450612E
24	053845	053845	Clip 5/16
26	2521372	272074	Closure 8 mm
30	2521307	304272	Elbow 3/8M-6
31	2661526	304943	Gasket for aerator
35	2801320	305744	PVC transparent tube 7-10
36	2521462	304397	Stem elbow 10-10 PM221010E
37	272097	272097	Peroxide silicone tube 12-8
38	2621105	208114	Small white elbow
39	2521360	272982	Straight fitting 3/8M-8 PM010813E
40	2521442	304387	Fitting 3/4F-8
41	2661711	304953	Gasket 3/4
43	2801368	272038	LLDPE pipe 6 mm
44	2801363	088113	LLDPE pipe 8 mm
50	2801406	305715	Teflon pipe 6 mm
56	2641140	208093	Solenoid valve 2 in - 1 out 230/1/50
59	2521120	304252	Aerator
60	2521119	304251	Nozzle in stainless steel
66	2521386	007448	Elbow 6-6 PM0306E

# Reservedelstegning HI-Class 45 IBACWG

HI-CLASS TOP 45 IB ACWG / CU / UV LED / TOUCHLESS R134a & R290

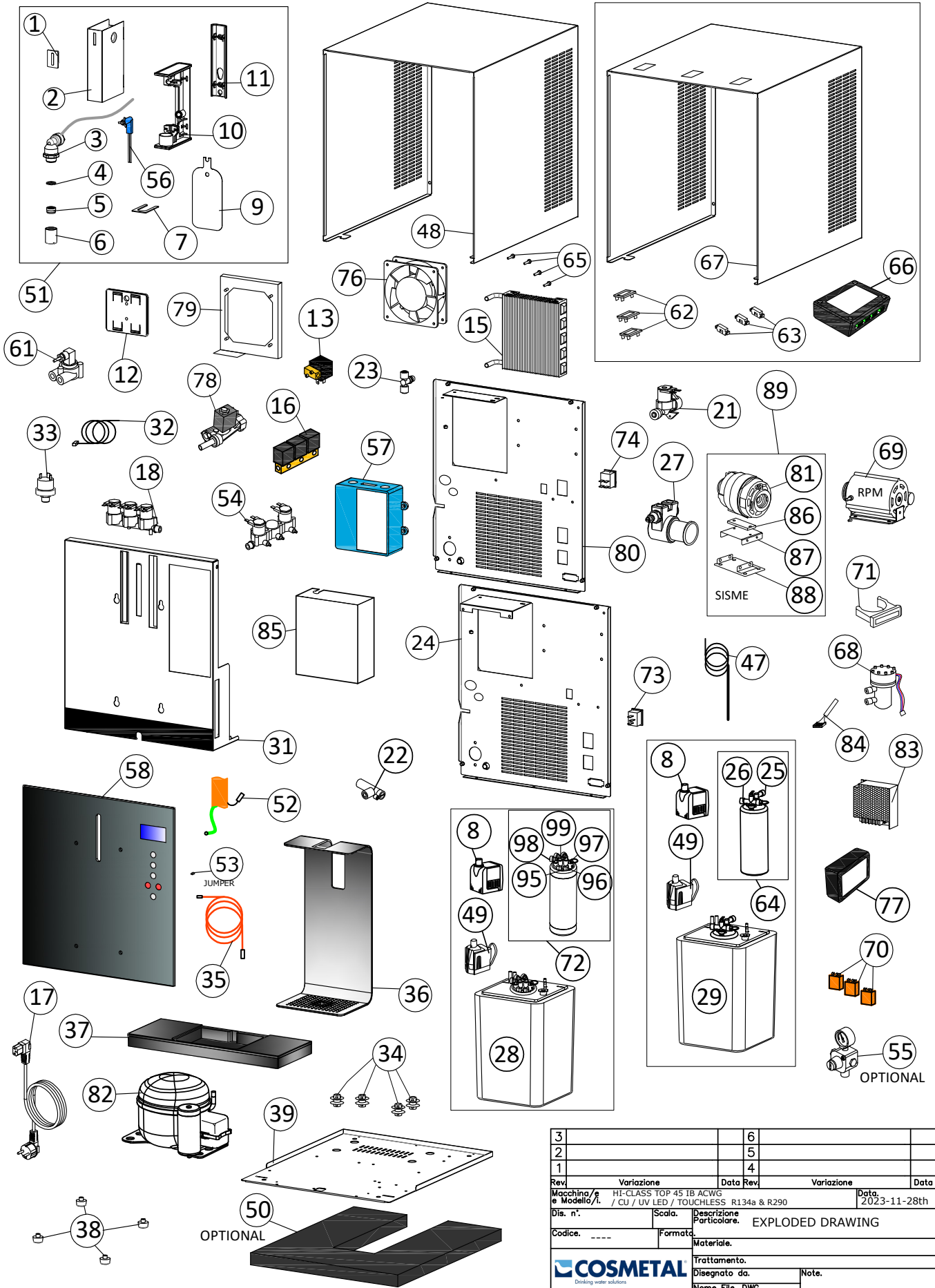

3		6		
2		5		
1		4		
Rev.	Variazione	Data Rev.	Variazione	Data
	Macchina/e	HI-CLASS TOP 45 IB ACWG		Data
	e Modello/A.	/ CU / UV LED / TOUCHLESS R134a & R290		2023-11-28th
	Dis. n°	Scala.	Descrizione Particolare.	
			EXPLODED DRAWING	
	Codice. ----	Formato.	Materiale.	
		Trattamento.		
		Disegnato da.	Note.	
		Nome File .DWG.		

QUESTO DISEGNO È TUTELATO DALLE LEGGI SUL COPYRIGHT - I TRASGRESSORI SARANNO PERSEGUITI A NORMA DI LEGGE

# Beskrivelse

POS:	COSMETAL	CELLI	DESCRIPTION
1	170111439	303361	Transparent plastic
2	170111435	303357	Dispenser cover stainless steel
3	304498 2521307	304498 304272	Brass elbow 3/8M-8 (CU-AG models) Elbow 3/8M-6
4	2661526	304943	Gasket for perlator
5	304262 2521120	304262 304252	Silver aerator (CU-AG models) Aertor in plastic
6	304267 2521119	304267 304251	Nozzle longer stainless steel (CU-AG models) Nozzle short standard stainless steel
7	170111443	303365	Fork stainless steel
8	227078	227078	Pump NEWA MC450 230/1/50-60
9	170111436	303358	Sliding cover
10	170111438	303360	Dispenser support
11	170111441	303363	Rear cover
12	170111442	303364	Friction element
13	2641128 228219	208158 228219	Brass solenoid valve 1 in - 1 out 1/8FF 230/1/50 Alternative brass solenoid valve CEME 1 in - 1 out 1/8FF 230/1/50
15	1601124	272027	Condenser
16	2641158	304853	Brass solenoid valve 3 in - 1 out 1/8FF 230/1/50
17	3821718	306071	Shuko power cord
18	2641127	208133	Plastic solenoid valve 3 in - 1 out 230/1/50
21	2641141 226098	210095 226098	Inlet solenoid valve 3/4M-6 230/1/50 Alternative EKI inlet solenoid valve 3/4M-6 230/1/50
22	2641164 2641131	304858 208078	Flow regulator 8-8 for sparkling water Flow regulator 6-6 for sparkling water
23	2521562	304488	Flow regulator 6-6
24	303325	303325	Rear panel version R134a
25	2521419	304369	Water inlet piping for carbonator
26	2521418 2641527 2641526	304368 304902 207944	CO2 inlet piping for carbonator Probe 112 mm + plastic ring Safety pressure valve
27	1761517006 213404	304227 213404	Brass pump 100l/h 3/8FF Brass pump 100l/h 1/4FF
28	307802	307802	Complete ice bank Hi-Class 45 ACWG for R134a
29	307897 213537 215324	307897 213537 215324	Complete ice bank Hi-Class 45 ACWG CU for R134a Complete ice bank Hi-Class 45 ACWG for R290 Complete ice bank Hi-Class 45 ACWG CU for R290
31	308743	308743	Front panel
32	306307	306307	CO2 sensor cable
33	306576	306576	Sensor for CO2 pressure
34	272026	272026	Anti-vibration support for compressor
35	3821961	306311	Connection cable
36	170111434	303356	Front element stainless steel
37	099283 302142	302029 302142	Complete drip tray Optional drip tray with drainage
38	2781686	272018	Foot 10 mm
39	170111357	303266	Base Hi-Class 45
47	3823961	209605	Ice bank sensor
48	303326	303326	Black cabinet
49	1501521	207934	Agitator Micromega 230/1/50
50	305649	305649	Optional base Hi-Class 45



# Beskrivelse

POS:	COSMETAL	CELLI	DESCRIPTION
51	099297	302041	Complete head kit Hi-Class 45 (not CU models)
52	3823006	306482	EMI filter
53	3821959	306309	Small black jumper
54	2641140	208093	Solenoid valve 2 in - 1 out 230/1/50
55	207930 208190 208131	207930 208190 208131	Optional pressure reducer for CO2 for rechargeable bottle Connection fitting 6 mm Optional pressure reducer for CO2 for single use bottle connection plastic fitting 6 mm Optional pressure reducer for CO2 for single use bottle connection brass fitting 6 mm
56	306633	306633	Blue LED
57	3823977 221063	209608 221063	Power PCB (standard) Power PCB with UV LED function
58	209611 221064	209611 221064	Complete front glass standard Complete front glass with UV LED function
61	3823001 3822938	306477 208127	Brass flow meter 1/4FF Plastic flow meter 1/4FF
62	107862	107862	Plastic bracket for touch less sensor
63	107870	107870	Touch less sensor
64	304752	304752	Carbonating unit 1l + probe
65	306752	306752	Screws M4x12 for cabinet closure
66	107924	107924	PCB for touch less sensors
67	303640	303640	Cabinet for Hi-Class 45 touch less
68	304591	304591	UV LED reactor Klaran
69	304214	304214	RPM motor 120W 230/1/50
70	306446	306446	Relay 230/1/50
71	306506	306506	Plastic support for UV reactor
72	2541510	304758	Carbonator steel and plastic 1l, 2 probes, 6 mm connections
73	040963	040963	IEC panel connector
74	3822714 215789	208160 215789	Main switch green for R134a Main switch black for R290
76	1761101604 304185	208963 304185	Condenser fan 120x120x25 for R134a Condenser fan 120x120x25 for R290
77	214522	214522	PCB for synchronized load
78	214254	214254	Solenoid valve with flow regulator 20/1/50
79	213000	213000	Conveyor
80	212127	212127	Rear panel R290 version
81	216018	216018	SISME motor 230/1/50
82	1581182 302587	302570 302587	Compressor Danfoss TL3F 230/1/50 for R34a Compressor Cubigel NBC22RA 230/1/50-60 for R290
83	216209	216209	Transformer 230-24VAC
84	220258	220258	Voltage divider
85	213490	213490	Sheet metal cover for power PCB
86	213879	213879	Anti-vibration plate for SISME motor
87	213419	213419	Bracket for SISME motor
88	213444	213444	Base for SISME motor
89	214315	214315	Complete SISME motor adapt kit
95	304494	304494	Probe 75 mm
96	304493	304493	Probe 225 mm
97	2641526	207944	Safety pressure valve
98	304410	304410	No return valve
99	2521478	304409	Inlet fitting for carbonator 6 mm

# Reservedelstegning Hi-Class 45 IBACHWG

HI-CLASS TOP 45 IB ACHWG / CU / UV LED / TOUCHLESS R134a & R290

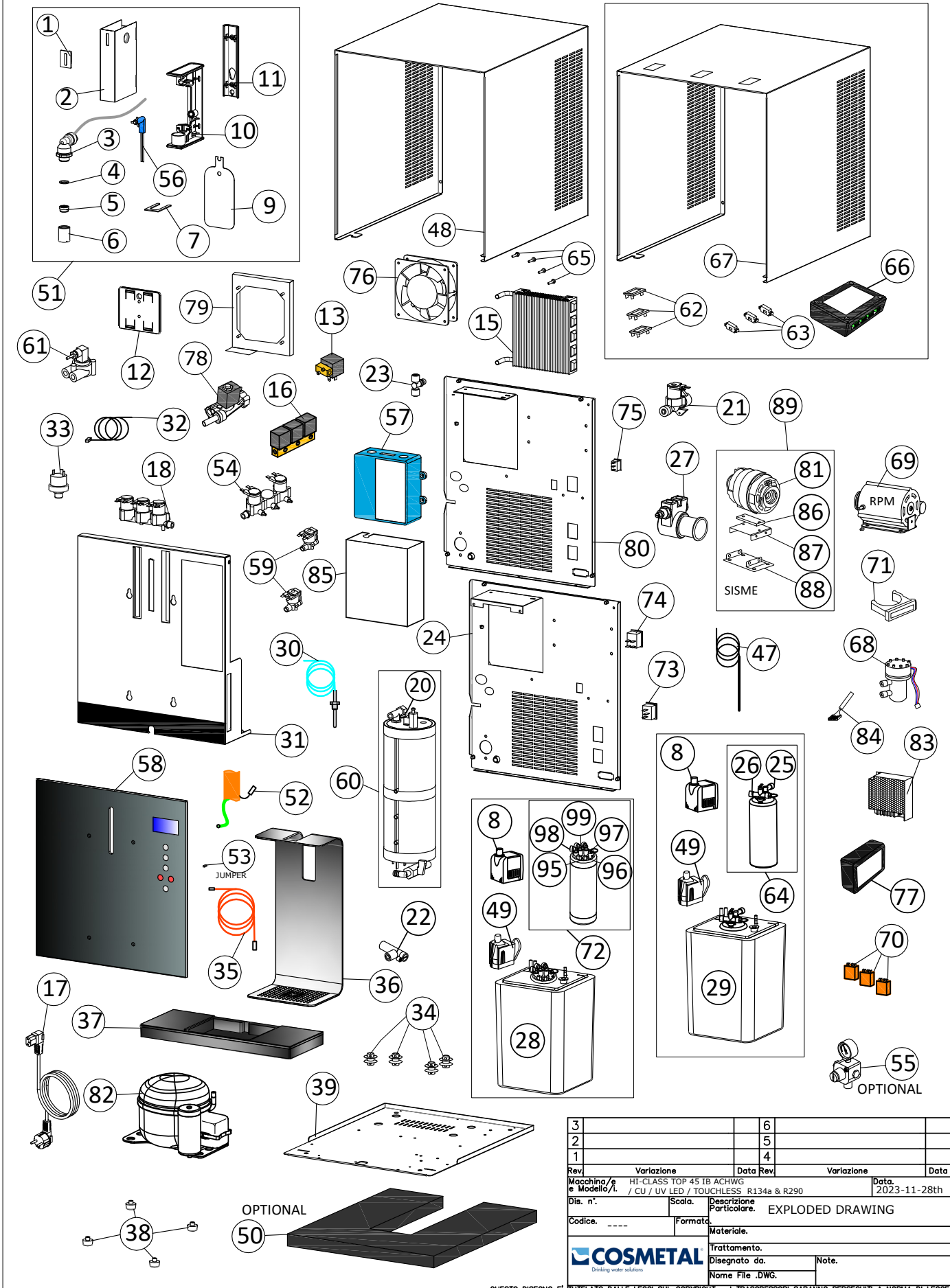

3		6		
2		5		
1		4		
Rev.	Variazione	Data Rev.	Variazione	Data
Macchina/e e Modello/i.		HI-CLASS TOP 45 IB ACHWG / CU / UV LED / TOUCHLESS R134a & R290		Data. 2023-11-28th
Dis. n°.	Scala.	Descrizione Particolare. EXPLODED DRAWING		
Codice.	Formato.	Materiale.		
Trattamento.		Disegnato da.		
Nome File .DWG.		Note.		

QUESTO DISEGNO È TUTELATO DALLE LEGGI SUL COPYRIGHT - I TRASGRESSORI SARANNO PERSEGUITI A NORMA DI LEGGE

# Beskrivelse

POS:	COSMETAL	CELLI	DESCRIPTION
1	170111439	303361	Transparent plastic
2	170111435	303357	Dispenser cover stainless steel
3	304498 2521307	304498 304272	Brass elbow 3/8M-8 (CU-AG models) Elbow 3/8M-6
4	2661526	304943	Gasket for perlator
5	304262 2521120	304262 304252	Silver aerator (CU-AG models) Aertor in plastic
6	304267 2521119	304267 304251	Nozzle longer stainless steel (CU-AG models) Nozzle short standard stainless steel
7	170111443	303365	Fork stainless steel
8	227078	227078	Pump NEWA MC450 230/1/50-60
9	170111436	303358	Sliding cover
10	170111438	303360	Dispenser support
11	170111441	303363	Rear cover
12	170111442	303364	Friction element
13	2641128 228219	208158 228219	Brass solenoid valve 1 in - 1 out 1/8FF 230/1/50 Alternative brass solenoid valve CEME 1 in - 1 out 1/8FF 230/1/50
15	1601124	272027	Condenser
16	2641158	304853	Brass solenoid valve 3 in - 1 out 1/8FF 230/1/50
17	3821718	306071	Shuko power cord
18	2641127	208133	Plastic solenoid valve 3 in - 1 out 230/1/50
20	3824927	306606	Safety thermostat 135 °C
21	2641141 226098	210095 226098	Inlet solenoid valve 3/4M-6 230/1/50 Alternative EKI inlet solenoid valve 3/4M-6 230/1/50
22	2641164 2641131	304858 208078	Flow regulator 8-8 for sparkling water Flow regulator 6-6 for sparkling water
23	2521562	304488	Flow regulator 6-6
24	303325	303325	Rear panel version R134a
25	2521419	304369	Water inlet piping for carbonator
26	2521418 2641527 2641526	304368 304902 207944	CO2 inlet piping for carbonator Probe 112 mm + plastic ring Safety pressure valve
27	1761517006 213404	304227 213404	Brass pump 100l/h 3/8FF Brass pump 100l/h 1/4FF
28	307802	307802	Complete ice bank Hi-Class 45 ACWG for R134a
29	307897 213537 215324	307897 213537 215324	Complete ice bank Hi-Class 45 ACWG CU for R134a Complete ice bank Hi-Class 45 ACWG for R290 Complete ice bank Hi-Class 45 ACWG CU for R290
30	3823959	306575	Hot water sensor for hot tank
31	308743	308743	Front panel
32	306307	306307	CO2 sensor cable
33	306576	306576	Sensor for CO2 pressure
34	272026	272026	Anti-vibration support for compressor
35	3821961	306311	Connection cable
36	170111434	303356	Front element stainless steel
37	099283 302142	302029 302142	Complete drip tray Optional drip tray with drainage
38	2781686	272018	Foot 10 mm
39	170111357	303266	Base Hi-Class 45
47	3823961	209605	Ice bank sensor
48	303326	303326	Black cabinet
49	1501521	207934	Agitator Micromega 230/1/50
50	305649	305649	Optional base Hi-Class 45

# Beskrivelse

POS:	COSMETAL	CELLI	DESCRIPTION
51	099297	302041	Complete head kit Hi-Class 45 (not CU models)
52	3823006	306482	EMI filter
53	3821959	306309	Small black jumper
54	2641140	208093	Solenoid valve 2 in - 1 out 230/1/50
55	207930 208190 208131	207930 208190 208131	Optional pressure reducer for CO2 for rechargeable bottle Connection fitting 6 mm Optional pressure reducer for CO2 for single use bottle connection plastic fitting 6 mm Optional pressure reducer for CO2 for single use bottle connection brass fitting 6 mm
56	306633	306633	Blue LED
57	3823977 221063	209608 221063	Power PCB (standard) Power PCB with UV LED function
58	209611 221064	209611 221064	Complete front glass standard Complete front glass with UV LED function
59	2641177	304869	Plastic solenoid valve 1 in - 1 out 230/1/50
60	2541955	304780	Hot water tank 230/1/50-1200W for Hi-Class 45
61	3823001 3822938	306477 208127	Brass flow meter 1/4FF Plastic flow meter 1/4FF
62	107862	107862	Plastic bracket for touch less sensor
63	107870	107870	Touch less sensor
64	304752	304752	Carbonating unit 1l + probe
65	306752	306752	Screws M4x12 for cabinet closure
66	107924	107924	PCB for touch less sensors
67	303640	303640	Cabinet for Hi-Class 45 touch less
68	304591	304591	UV LED reactor Klaran
69	304214	304214	RPM motor 120W 230/1/50
70	306446	306446	Relay 230/1/50
71	306506	306506	Plastic support for UV reactor
72	2541510	304758	Carbonator steel and plastic 1l, 2 probes, 6 mm connections
73	040963	040963	IEC panel connector
74	3822714 215789	208160 215789	Main switch green for R134a Main switch black for R290
75	3822712	306354	Auxiliary switch for hot tank (red)
76	1761101604 304185	208963 304185	Condenser fan 120x120x25 for R134a Condenser fan 120x120x25 for R290
77	214522	214522	PCB for synchronized load
78	214254	214254	Solenoid valve with flow regulator 20/1/50
79	213000	213000	Conveyor
80	212127	212127	Rear panel R290 version
81	216018	216018	SISME motor 230/1/50
82	1581182 302587	302570 302587	Compressor Danfoss TL3F 230/1/50 for R34a Compressor Cubigel NBC22RA 230/1/50-60 for R290
83	216209	216209	Transformer 230-24VAC
84	220258	220258	Voltage divider
85	213490	213490	Sheet metal cover for power PCB
86	213879	213879	Anti-vibration plate for SISME motor
87	213419	213419	Bracket for SISME motor
88	213444	213444	Base for SISME motor
89	214315	214315	Complete SISME motor adapt kit
95	304494	304494	Probe 75 mm
96	304493	304493	Probe 225 mm
97	2641526	207944	Safety pressure valve
98	304410	304410	No return valve
99	2521478	304409	Inlet fitting for carbonator 6 mm

## HI-CLASS TOP 45 IB ACWG HI-CLASS TOP 45 IB ACHWG

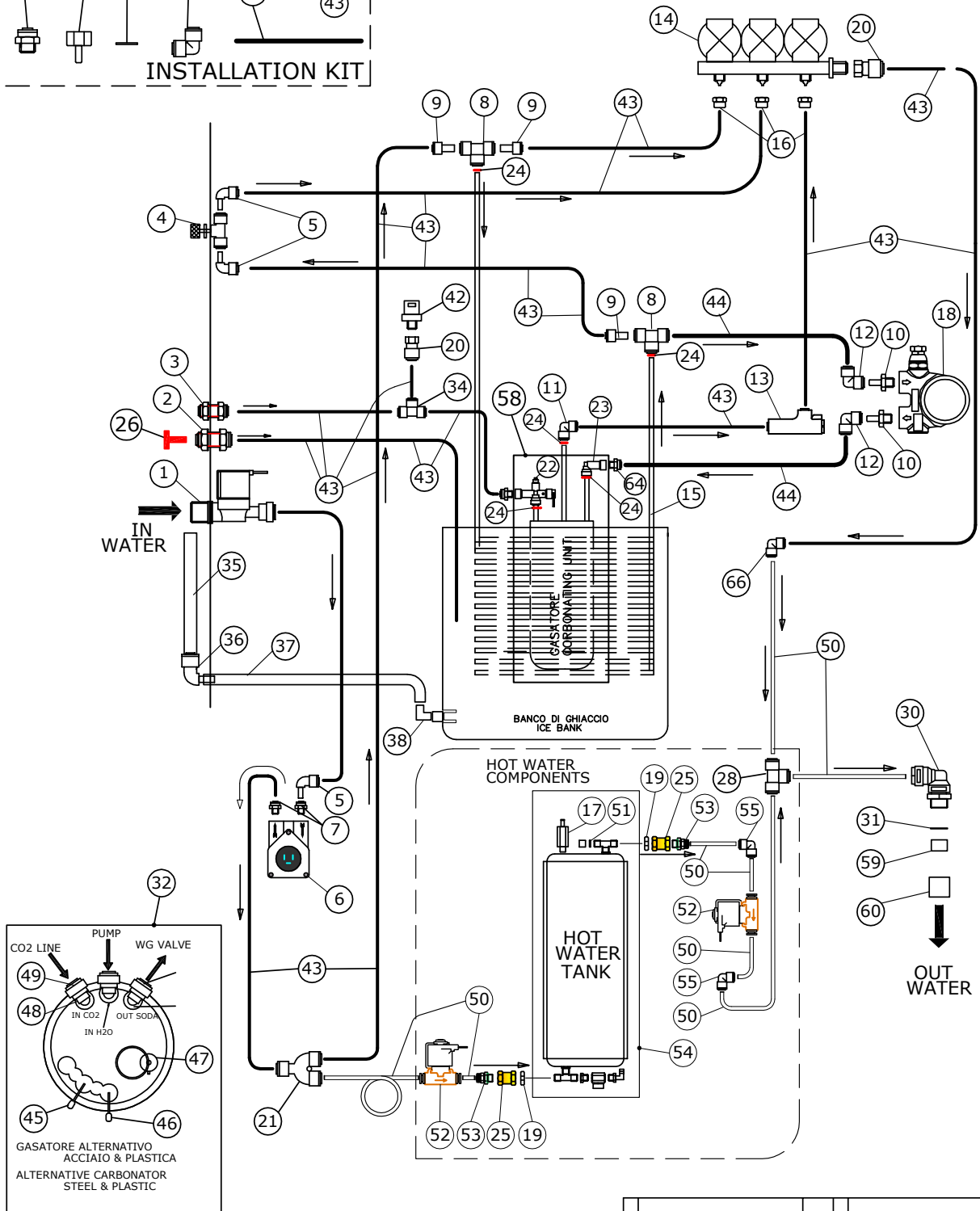
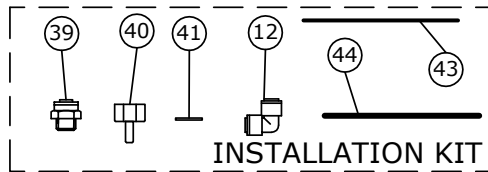

2				
1				
Data: 11-6-2024		MACCHINA HI-CLASS TOP 45 IB ACWG HI-CLASS TOP 45 IB ACHWG		
COSMETAL Drinking water solutions		Descrizione HYDRAULIC DIAGRAM		
		Note.		

QUESTO DISEGNO E' TUTELATO DALLE LEGGI SUL COPYRIGHT - I TRASGROSSORI SARANNO PERSEGUITI A NORMA DI LEGGE

# Beskrivelse

POS:	COSMETAL	CELLI	DESCRIPTION
1	2641141 226880	210095 226880	Inlet solenoid valve 3/4M-6 230/1/50 Alternative SEME inlet solenoid valve 3/4M-6 230/1/650
2	2521490	272073	Bulkhead connector 8-6 HMM0806
3	2521415	068501	Bulkhead connector 6-6 NC2478-P
4	2521562	304488	Flow regulator 6-6 ambient water
5	2521454	272105	Stem elbow 6-6 PM220606E
6	3822938	208127	Plastic flow meter 1/4FF
7	2521413	008642	Straight connection 1/4M-6 PM010612E
8	2521364	271984	T fitting JG8 PM0208E
9	2521453	272104	Straight reduction Stem 8 - 6 PM060806E
10	2521363	007446	Straight fitting 3/8M - stem 8 PM050813E
11	2521436	272034	Reduction elbow 8-6 PM210806E
12	2521367	272166	Elbow 8-8 PM0308E
13	2621131	208078	Flow regulator 6-6 for sparkling water
14	2641127	208133	Triple solenoid valve 3 in - 1 out 230/1/50
15	1601494	302766	Water coil ø8 45l/h
16	4741312	208168	Nut
17	222392	222392	Brass safety pressure valve 14 bar for the hot tank
18	1761517006	304227	Brass pump 100l/h 3/8FF
19	4741331	306682	Nut 1/4
20	2521420	208119	Fitting 1/4F-6 PM450612E
21	2521473	046603	Y fitting 6-6-6 RM2306E
22	2521418 304410 2641527 2641526	304368 304410 304902 207944	CO2 inlet piping for carbonator No return valve 112 mm probe + bushing Safety valve
23	2521419 304410	304369 304410	Inlet water piping for carbonator No return valve
24	053845	053845	Clip 5/16
25	2621145	210101	Fitting 1/4FF
26	2521372	272074	Closure 8 mm
28	2521521	304448	White tee high temperature 6-6-6
30	2521307	304272	Elbow 3/8M-6
31	2661526	304943	Gasket for aerator
34	2521385	304286	Tee 6 PM0206E
35	2801320	305744	PVC transparent tube 7-10
36	2521462	304397	Stem elbow 10-10 PM221010E
37	272097	272097	Peroxide silicone tube 12-8
38	2621105	208114	Small white elbow
39	2521360	272982	Straight fitting 3/8M-8 PM010813E
40	2521442	304387	Fitting 3/4F-8
41	2661711	304953	Gasket 3/4
42	3823960	306576	CO2 pressure sensor Hi-Class 45
43	2801368	272038	LLDPE pipe 6 mm
44	2801363	088113	LLDPE pipe 8 mm
45	2521568	304494	Probe 75 mm
46	2521567	304493	Probe 225 mm
47	2641526	207944	Security pressure valve
48	304410	304410	No return valve
49	2521478	304409	Inlet fitting for carbonator 6 mm
50	2801406	305715	Teflon pipe 6 mm

## Beskrivelse

POS:	COSMETAL	CELLI	DESCRIPTION
51	2661504	304926	Silicone gasket
52	2641177	304869	Solenoid valve 6-6 230/1/50
53	2521491	304420	Straight adaptor 1/4M-6
54	2541955	304780	Hot water tank Hi-Class 45
55	304475	304475	White elbow 6-6 for high temperature
58	2541504	304752	Carbonator 1l + probe
59	2521120	304252	Aerator
60	2521119	304251	Nozzle in stainless steel
64	007362	007362	Straight fitting 1/4M-8
66	2521386	007448	Elbow 6-6 PM0306E



# FESTIVO PORKKA

## Colia AS - et selskap i Festivo Porkka Group

Gruppen har en samlet omsetning på cirka NOK 500 millioner og sysselsetter omtrent 300 personer. Vi er representert i UK, Sverige, Norge, Øst Europa og Sentral Europa. Hovedkontoret samt fabrikker er lokalisert i Finland.

Alle produktene i Porkka`s sortiment selges kun gjennom Colia AS. I tillegg importerer vi kjente merkevarer som Migel (Porkka) ismaskiner, Sinofcold, Liebherr, Igloo, Asber, Cosmetal, Vestfrost, Elcold osv.

Vår visjon er å levere produkter med høy kvalitet og yte god service til våre kunder.

---

# °COLIA

Colia AS  
Ringeriksveien 16, 3414 Lierbyen

post@colia.no | www.colia.no | +47 66 98 77 77