

RESERVEDELER COSMETAL HI-CLASS TOP 30

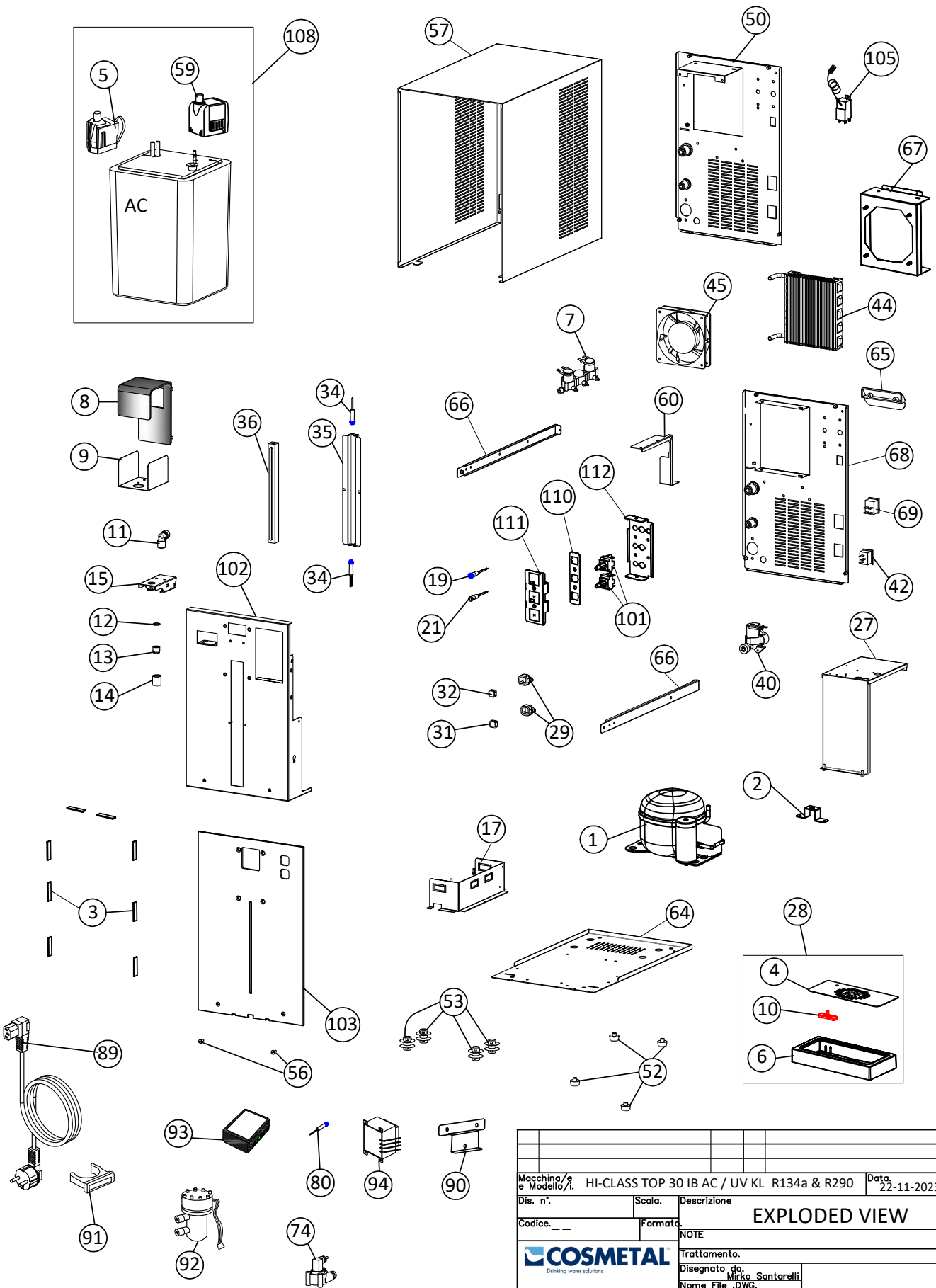

HI-CLASS TOP 30 IB AC / UV KL R134a & R290



Macchina/e e Modello/i		HI-CLASS TOP 30 IB AC / UV KL R134a & R290	Data	22-11-2023
Dis. n°	Scala	Descrizione	EXPLODED VIEW	
Codice	Formato	NOTE		
COSMETAL Drinking water solutions		Trattamento.		
		Disegnato da	Mirko Santarelli	
		Nome File	.DWG.	

Beskrivelse

POS:	COSMETAL	CELLI	DESCRIPTION
1	1581182 302587	302570 302587	Compressor Secop TL3F for R134a 230/1/50 Compressor Cubigel NBC22RA for R290 230/1/50-60
2	309358	309358	Bracket for condenser
3	307663	307663	Kit 4 strips 40x10x2 mm
4	303539	303539	Stainless steel grille
5	1501521	207934	Agitator Micromega 230/1/50
6	099448 099447	305655 305656	Plastic drip tray white Plastic drip tray black
7	2641140	208093	Solenoid valve 2 in - 1 out 230/1/50
8	170111498	303421	Dispensing head
9	170111499	303422	Cover for dispensing head
10	3824532	305657	Red LED
11	2521642	304568	Elbow 3/8M-6 white HPL06R03W CDC
12	2661526	304943	Gasket for perlator
13	2521120	304252	Aerator perlator
14	2521119	304251	Nozzle stainless steel
15	303423	303423	Bracket for nozzle
17	170111406	303328	Block ice bank for Hi-Class
19	3824533	208164	Blue LED
21	3824534	208138	White LED
27	170111002	302916	Metal divider
28	099447 099448	308861 308858	Complete drip tray kit black V19 Complete drip tray kit white V19
29	2781786	305554	Light diffuser for buttons (transparent plastic)
31	815613185 815613184	210179 307995	Button 14x14 black print "F" Button 14x14 white print "F"
32	815613183 815613182	307994 307993	Button 14x14 black print "A" Button 14x14 white print "A"
34	3824540	306641	Blue LED IP&% 60°
35	170111520	226091	Omega fix plexi Hi-Class
36	2781871	305631	Frontal plastic light diffuser Hi-Class 20/30/65
40	226098 2641141	226098 210095	Alternative solenoid valve 3/4M-JG6 230/1/50 Inlet solenoid valve 3/4M-6 230/1/50
42	3824515	040963	IEC power connector
44	1601124	272027	Condenser
45	1761101604 304185	208963 304185	Condenser fan motor 120x120x25 230/1/50 for R134a Condenser fan motor XFAN RAH1225B1 120x120x25 230/1/50 for R290
50	170111500	303432	Rear panel R134a
52	2781686	272018	Rubber feet H=10 mm
53	272026	272026	Anti-vibration support for compressor
56	306817 306818	306817 306818	Screw M4 x 10 white plastic Screw M4 x 10 black plastic
57	170111532 170111510	303455 226123	Cabinet Hi-Class 30 white Cabinet Hi-Class 30 black
59	227078	227078	Agitator NEWA MC450 230/1/50-60
60	302920	302920	Bracket for solenoid valve
64	170111512	303435	Base Hi-Class 30
65	2781346	305183	Black plastic handle
66	303436	303436	Side beam Hi-Class 30
67	309539	309539	Conveyor
68	170111500	212740	Rear panel

Beskrivelse

POS:	COSMETAL	CELLI	DESCRIPTION
69	3822714 215789	208160 215689	Main switch green for R134a Main switch black for R290
74	3822938	208127	Flow meter plastic
80	306643	306643	LED "UV status)
89	3821718	306071	Shuko power cord
90	303612	303612	Metal bracket for UV reactor
91	306506	306506	Plastic bracket for UV reactor
92	304591	304591	Klaran UV reactor
93	306383	306383	PCB 3822749 for UV reactor
94	210615	210615	Transformer TR1524 230 - 24V 15VA
101	208167	208167	Electric button 4 pin
102	170111502	303428	Front panel Hi-Class 20/30
103	2781883 2781882	305662 305663	Front panel white plastic AC Front panel black plastic AC
105	1761517008 306645	207955 306645	Thermostat for ice bank R134a Thermostat for ice bank R290
108	213124 307773	213124 307773	Ice bank for AC R290 Ice bank for AC R134a
110	303424	303424	Metal closer for light diffuser
111	226181	226181	Metal support for light diffuser
112	303426	303426	Metal support for buttons



Dryppanne til venstre fra V19
Sort dryppanne 099447 - hvit 099448

Dryppanne til høyre før V19
Sort 2781866 - hvit 170111511

HI CLASS TOP 30 IB AC (EC) / UV LED KL

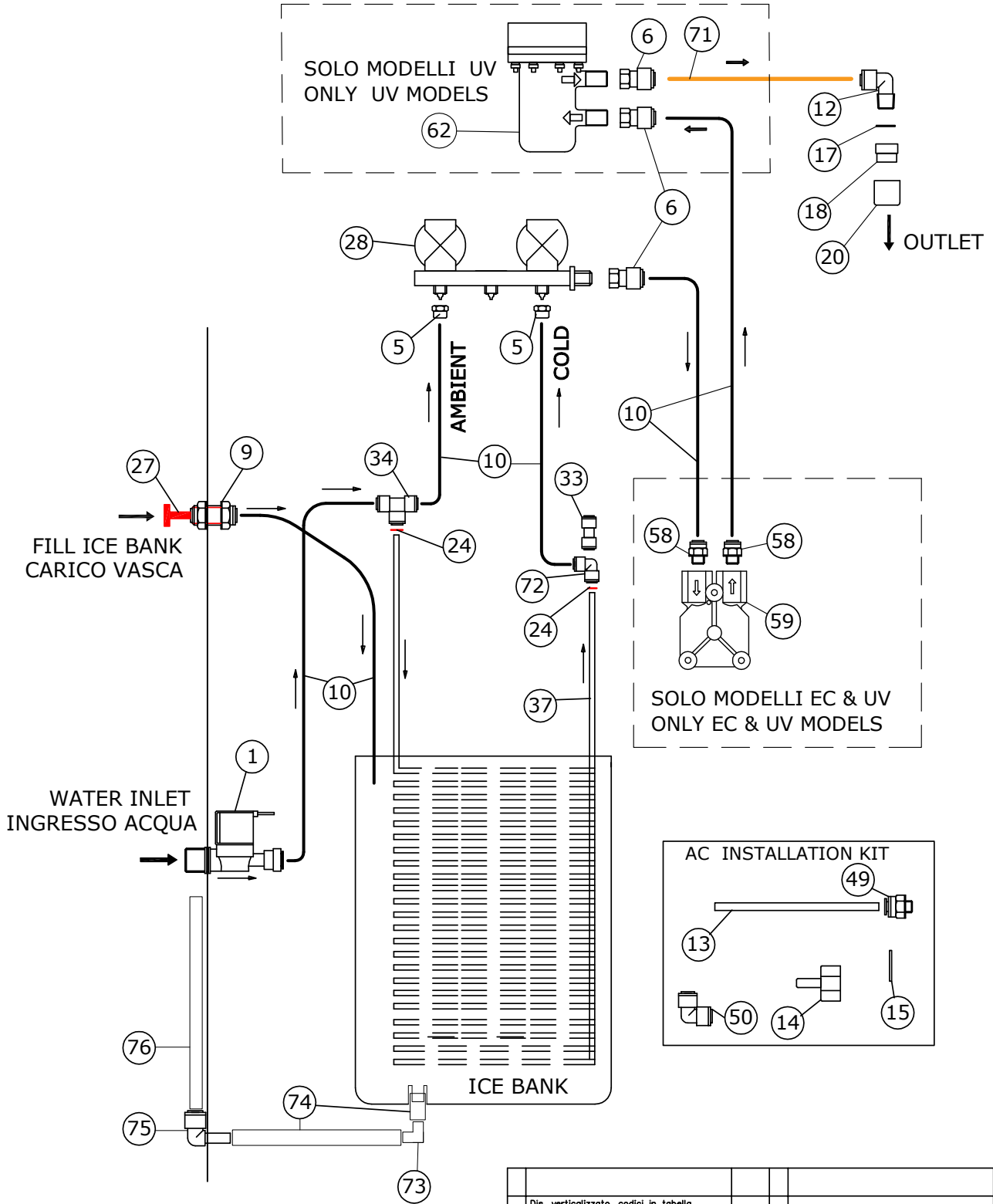

HI CLASS TOP 30 IB AC
 HI CLASS TOP 30 IB AC EC
 HI CLASS TOP 30 IB AC UV
 HI CLASS TOP 30 IB AC EC UV

2	Dis. verticalizzato, codici in tabella	6.6.24		
1	Item 72 al posto item 33 (dritto 6-6) Disegnato tubo livello	10.1.23		
Data. 2022-9-5th		MACCHINA		
		HI CLASS TOP 30 IB AC (EC) UV KL R290		
		Descrizione		
COSMETAL® Drinking water solutions		HYDRAULIC DIAGRAM		
		Note.		

QUESTO DISEGNO È TUTELATO DALLE LEGGI SUL COPYRIGHT - I TRASGRESSORI SARANNO PERSEGUITI A NORMA DI LEGGE

Beskrivelse

POS:	COSMETAL	CELLI	DESCRIPTION
1	2641141 226880	210095 226880	Inlet solenoid valve 3/4M - 6 230/1/50 Alternative inlet solenoid valve 3/4M - 6 230/1/50
5	4741312	208168	Nut
6	2521420	208119	Fitting 1/4F-6 PM450612E
9	2521490	272073	Bulkhead connector 8-6
10	2801368	272038	Tube 6 mm LDPE
12	2521642	304568	Elbow 3/8M-6
13	2801363	088113	Tube 8 mm LDPE
14	2521442	304387	Fitting 3/4F-8
15	2661711	304953	Gasket 3/4
17	2661526	304943	Gasket for aerator
18	2521120	304252	Aerator
20	2521119	304251	Nozzle in stainless steel
24	2521429	272035	Clip 1/4
27	2521372	272074	Closure ø8
28	2641140	208093	Solenoid valve 230/1/50 2 in - 1 out
33	2521422	304371	Straight fitting 6-6 PM0406E
34	2521385	304286	Tee 6 PM0206E
37	16011325	272181	Water coil 30l/h
49	2521360	272982	Straight fitting 3/8M-8 PM010813E
50	2521367	272166	Elbow 8-8 PM0308E
58	008642	008642	Straight 1/4M-6 PM010612E
59	208127	208127	Flow meter plastic 1/4FF
62	304591	304591	UV reactor KLARAN
71	302773	302773	Copper pipe long ø6
72	2521386	007448	Equal elbow 6-6 PM0306E
73	2621105	208114	Elbow white small
74	272097	272097	Peroxidic silicone pipe 12-8
75	304397	304397	Stem elbow 10-10 PM221010E
76	305744	305744	PVC Transparent tube 7-10

HI-CLASS TOP 30 IB ACWG / UV KL / TOUCHLESS R134a & R290

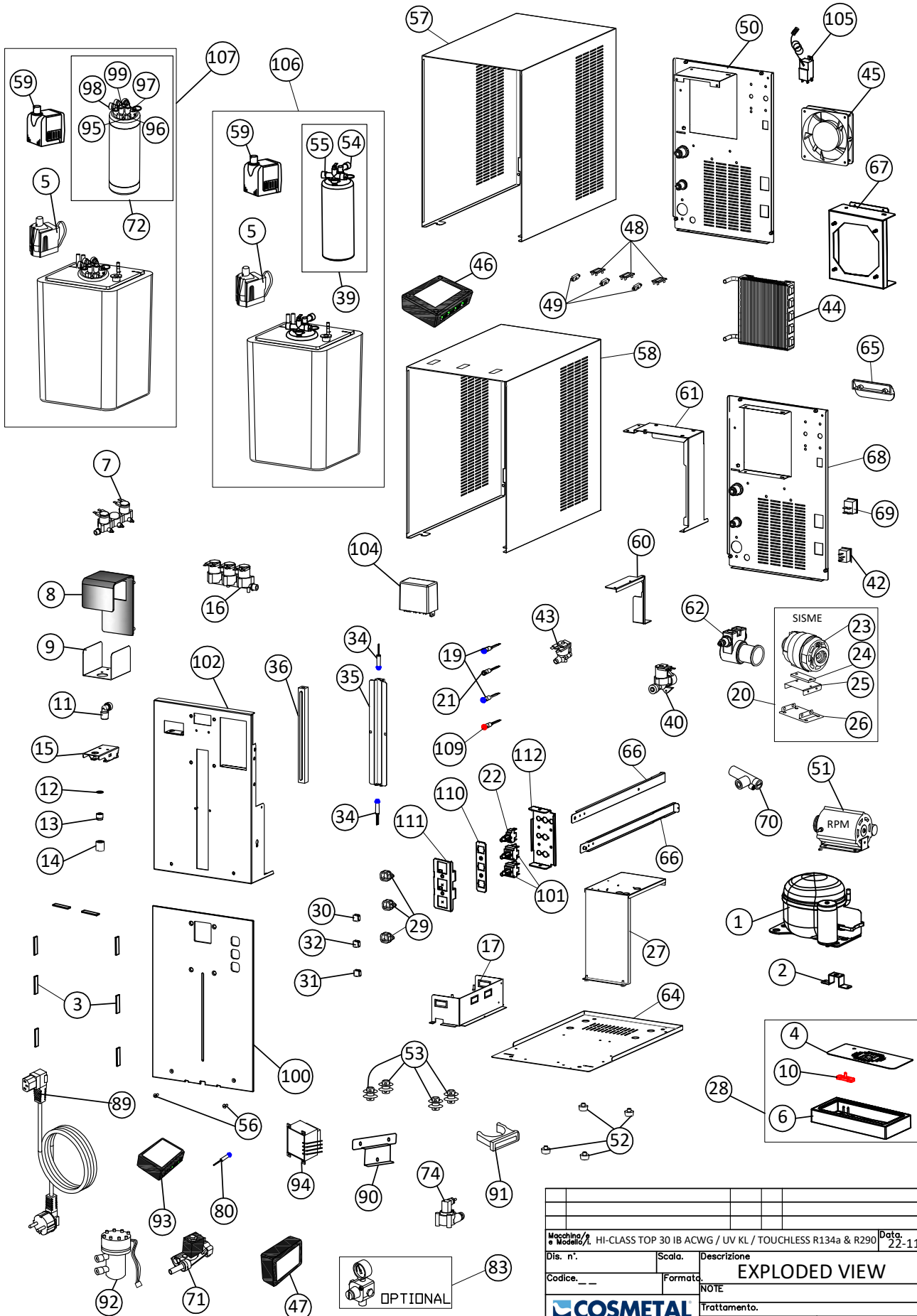

Macchina/Modello		HI-CLASS TOP 30 IB ACWG / UV KL / TOUCHLESS R134a & R290		Data	22-11-2023
Dis. n°	Scala	Descrizione			
Codice	Formato	EXPLODED VIEW			
NOTE					
Trattamento		Disegnato da: Mirko Santarelli			
Nome File .DWG					

Beskrivelse

POS:	COSMETAL	CELLI	DESCRIPTION
1	1581182 302587	302570 302587	Compressor Secop TL3F for R134a 230/1/50 Compressor Cubigel NBC22RA for R290 230/1/50-60
2	309358	309358	Bracket for condenser
3	307663	307663	Kit 4 strips 40x10x2 mm
4	303539	303539	Stainless steel grille
5	1501521	207934	Agitator Micromega 230/1/50
6	099448 099447	305655 305656	Plastic drip tray white Plastic drip tray black
7	2641140	208093	Solenoid valve 2 in - 1 out 230/1/50
8	170111498	303421	Dispensing head
9	170111499	303422	Cover for dispensing head
10	3824532	305657	Red LED
11	2521642	304568	Elbow 3/8M-6 white HPL06R03W CDC
12	2661526	304943	Gasket for perlator
13	2521120	304252	Aerator perlator
14	2521119	304251	Nozzle stainless steel
15	303423	303423	Bracket for nozzle
16	2661711	208133	Solenoid valve 3 in - 1 out 230/1/50
17	170111406	303328	Block ice bank for Hi-Class
19	3824533	208164	Blue LED
21	3824534	208138	White LED
22	306377	306377	Electric button 2 pin
23	216018	216018	SISME motor 230/1/50
24	213879	213879	Anti-vibration plate for motor
25	213419	213419	Lower bracket for motor
26	213444	213444	Base for SISME motor
27	170111002	302916	Metal divider
28	099447 099448	308861 308858	Complete drip tray kit black V19 Complete drip tray kit white V19
29	2781786	305554	Light diffuser for buttons (transparent plastic)
30	815613187 815613186	307997 307996	Key 14 x 14 black print "WG" Key 14 x 14 white print "WG"
31	815613185 815613184	210179 307995	Button 14x14 black print "F" Button 14x14 white print "F"
32	815613183 815613182	307994 307993	Button 14x14 black print "A" Button 14x14 white print "A"
34	3824540	306641	Blue LED IP&% 60°
35	170111520	226091	Omega fix plexi Hi-Class
36	2781871	305631	Frontal plastic light diffuser Hi-Class 20/30/65
39	2541504	304752	Carbonator 1l - 1 probe
40	226098 2641141	226098 210095	Alternative solenoid valve 3/4M-JG6 230/1/50 Inlet solenoid valve 3/4M-6 230/1/50
42	3824515	040963	IEC power connector
43	304869	304869	Solenoid valve serie TV2 6-6 230/1/50
44	1601124	272027	Condenser
45	1761101604 304185	208963 304185	Condenser fan motor 120x120x25 230/1/50 for R134a Condenser fan motor XFAN RAH1225B1 120x120x25 230/1/50 for R290
46	107924	107924	PCB for touch less CL107924
47	214522	214522	PCB synchronized load
48	107862	107862	Plastic bracket for touch less sensor
49	107870	107870	Touch less sensor

Beskrivelse

POS:	COSMETAL	CELLI	DESCRIPTION
50	170111500	303432	Rear panel R134a
51	216018	304214	RPM motor 230/1/50
52	2781686	272018	Rubber feet H=10 mm
53	272026	272026	Anti-vibration support for compressor
54	2521419	304369	Water inlet piping of carbonator
55	2521418 2641527	304368 304902	CO2 inlet piping of carbonator Probe 112 mm + plastic ring
56	306817 306818	306817 306818	Screw M4 x 10 white plastic Screw M4 x 10 black plastic
57	170111532 170111510	303455 226123	Cabinet Hi-Class 30 white Cabinet Hi-Class 30 black
58	212981 303637	212981 303637	White housing for touch less Black housing for touch less
59	227078	227078	Agitator NEWA MC450 230/1/50-60
60	302920	302920	Bracket for solenoid valve
61	303444	303444	Support for motor pump
62	1761517006	304227	Pump 3/8FF 100l/h
64	170111512	303435	Base Hi-Class 30
65	2781346	305183	Black plastic handle
66	303436	303436	Side beam Hi-Class 30
67	309539	309539	Conveyor
68	170111500	212740	Rear panel
69	3822714 215789	208160 215689	Main switch green for R134a Main switch black for R290
70	2641131	208078	Flow regulator 6-6
72	815011114	214254	Complete carbonator steel plastic 1l
74	3822938	208127	Flow meter plastic
80	306643	306643	LED (UV status)
83	207930 208190 208131	207930 208190 208131	Optional pressure reducer for CO2 for rechargeable bottle Connection fitting 6 mm Optional pressure reducer for CO2 for single use bottle connection plastic fitting 6 mm Optional pressure reducer for CO2 for single use bottle connection brass fitting 6 mm
89	3821718	306071	Shuko power cord
90	303612	303612	Metal bracket for UV reactor
91	306506	306506	Plastic bracket for UV reactor
92	304591	304591	Klaran UV reactor
93	306383	306383	PCB 3822749 for UV reactor
94	210615	210615	Transformer TR1524 230 - 24V 15VA
95	304494	304494	Probe 75 mm
96	304493	304493	Probe 225 mm
97	207944	207944	Safety pressure valve
98	304410	304410	No return valve
99	304409	304409	Inlet fitting for carbonator ø6
100	2781882 2781883	305660 305661	Plastic front panel white for ACWG Plastic front panel black for ACWG
101	208167	208167	Electric button 4 pin
102	170111502	303428	Front panel Hi-Class 20/30
104	209613 209612	209613 209612	PCB level control 3821914 PCB level control 3821956
105	1761517008 306645	207955 306645	Thermostat for ice bank R134a Thermostat for ice bank R290
106	307774	307774	Ice bank for R290
107	212795	212795	Ice bank for R134a

Beskrivelse

109	3824532	306635	Red light
110	303424	303424	Metal closer for light diffuser
111	226181	226181	Metal support for light diffuser
112	303426	303426	Metal support for buttons

Hydrotegning Hi-Class 30 IBACWG

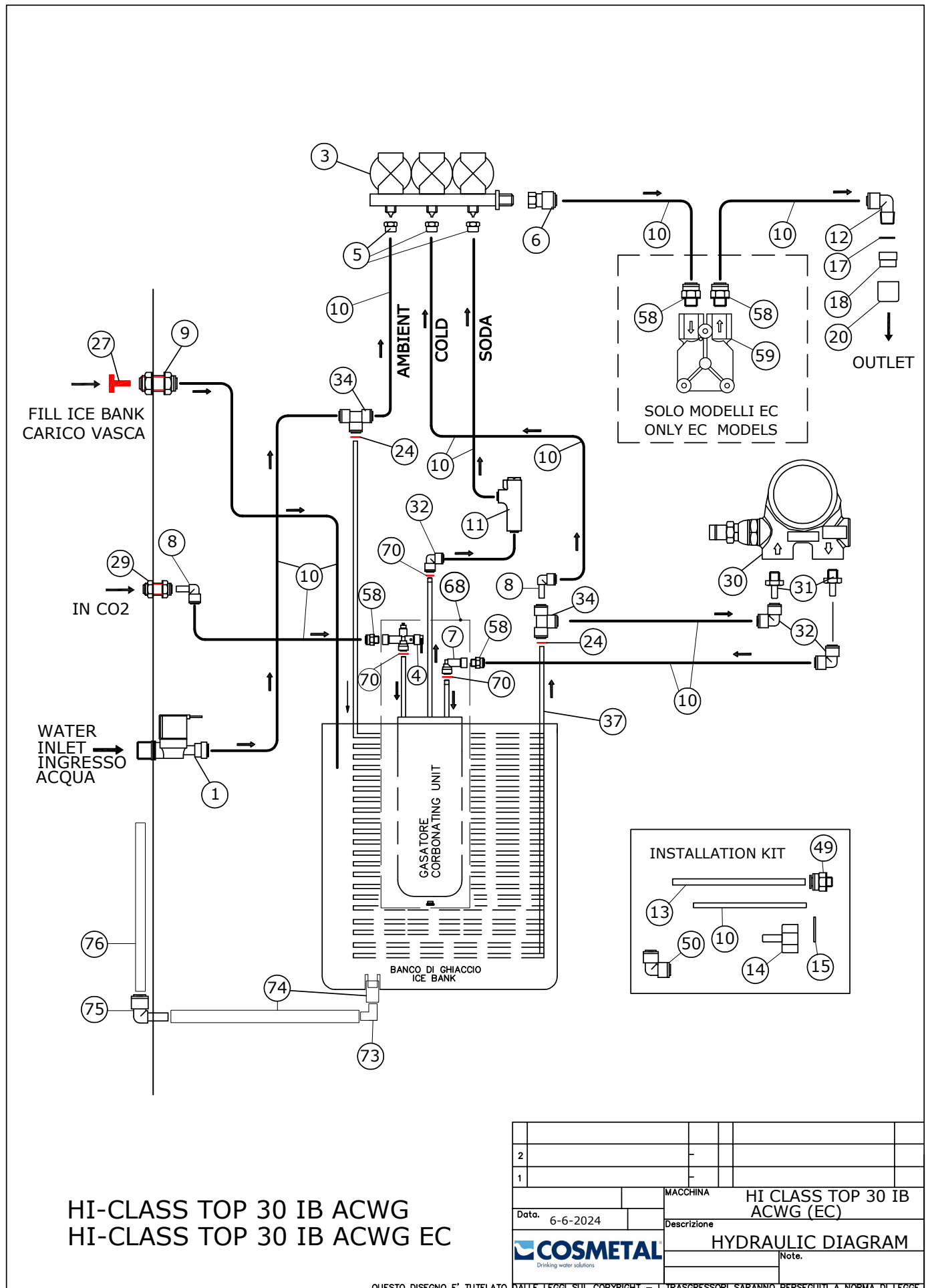

2				
1				
		MACCHINA	HI CLASS TOP 30 IB ACWG (EC)	
	Date.	6-6-2024	Descrizione	
			HYDRAULIC DIAGRAM	
			Note.	

Beskrivelse

POS:	COSMETAL	CELLI	DESCRIPTION
1	2641141 226880	210095 226880	Inlet solenoid valve 3/4M - 6 230/1/50 Alternative inlet solenoid valve 3/4M - 6 230/1/50
3	2641127	208133	Triple solenoid valve 3 in - 1 out 230/1/50
4	2521418 304410 2641527 2641526	304368 304410 2641527 304902	Inlet piping CO2 carbonator No return valve 112 mm probe + bushing Security valve
5	4741312	208168	Nut
6	2521420	208119	Fitting 1/4F-6 PM450612E
7	2521419 304410	304369 304410	Water inlet piping for carbonator No return valve
8	2521454	272105	Stem Elbow 6-6 PM220606E
9	2521490	272073	Bulkhead connector 8-6
11	2641131	208078	Flow regulator 6-6 for sparkling water
12	2521642	304568	Elbow 3/8M-6
13	2801363	088113	Tube 8 mm LDPE
14	2521442	304387	Fitting 3/4F-8
15	2661711	304953	Gasket 3/4
17	2661526	304943	Gasket for aerator
18	2521120	304252	Aerator
20	2521119	304251	Nozzle in stainless steel
24	2521429	272035	Clip 1/4
27	2521372	272074	Closure ø8
29	2521454	068501	Bulkhead connector 6-6 NC2478-P
30	1761517006	304227	Brass pump 100l/h 3/8FF
31	2521363	007446	Straight 3/8M-stem 8 PM050813E
32	2521436	272034	Reduction elbow 8-6 PM210806E
34	2521385	304286	Tee 6 PM0206E
37	16011325	272181	Water coil 30l/h
49	2521360	272982	Straight fitting 3/8M-8 PM010813E
50	2521367	272166	Elbow 8-8 PM0308E
58	2521413	008642	Straight adaptor 1/4M-6 PM010612E
59	208127	208127	Plastic flow meter 1/4FF
60	304290	304290	Straight 1/4M- stem 6 PM050612E
61	304288	304288	Fitting 1/4F-8 PM450812E
62	304591	304591	UV reactor Klaran
63	214772	214772	Copper pipe ø8
64	214254	214254	Solenoid valve 8-8 with regulator 230/1/50
65	2521453	272103	Straight reduction 8-6 PM200806E
66	214784	214784	Copper pipe ø6 short
67	2641177	304869	Solenoid valve 6-6 230/1/50
68	2541510	304752	Carbonator 1l + probe
70	CL053845	CL053845	Clip 5/16
73	2621105	208114	Elbow small white
74	272097	272097	Peroxidic silicone pipe 12-8
75	304397	304397	Stem elbow 10-10 PM221010E
76	305744	305744	PVC Transparent tube 7-10



FESTIVO
PORKKA

Colia AS - et selskap i Festivo Porkka Group

Gruppen har en samlet omsetning på cirka NOK 500 millioner og sysselsetter omtrent 300 personer. Vi er representert i UK, Sverige, Norge, Øst Europa og Sentral Europa. Hovedkontoret samt fabrikker er lokalisert i Finland.

Alle produktene i Porkka`s sortiment selges kun gjennom Colia AS.
I tillegg importerer vi kjente merkevarer som Migel (Porkka) ismaskiner, Sinofcold, Liebherr, Igloo, Asber, Cosmetal, Vestfrost, Elcold osv.

Vår visjon er å levere produkter med høy kvalitet og yte god service til våre kunder.

°COLIA

Colia AS
Ringeriksveien 16, 3414 Lierbyen

post@colia.no | www.colia.no | +47 66 98 77 77